

INSTALLATION GUIDE

Before beginning installation, read through all information and instructions in this installation guide.

Your shipping carton should arrive with the following items:

- a. Helius 4550
- b. Remote control and batteries
- c. Power Cord
- d. 2-way Satellite Splitter
- e. ABC Switch
- f. (5) 3' RF coax cables
- g. (1) 6' RF coax cable

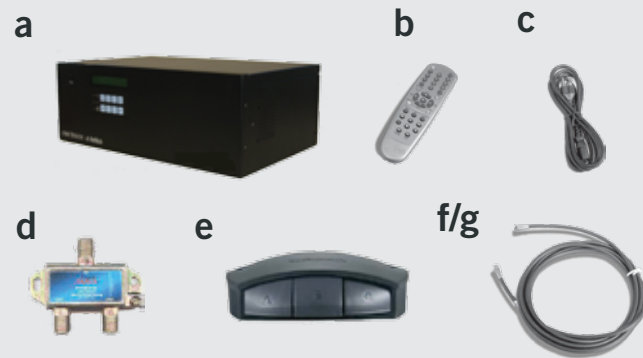

Keep equipment in its original packaging until ready to install in order to prevent damage.

 **Dangerous voltage. Electric Shock Hazard.**

 **Follow the safety instructions below:**

- » DO NOT unplug the device unless it has been properly shut down.
- » DO NOT open or expose the internal parts of the equipment.
- » Always allow the temperature of the equipment to stabilize to normal room temperature before using. Prevent exposure to extreme hot or cold temperatures.
- » DO NOT place the equipment close to an external source of heat such as a radiator or heating vent, or near appliances generating magnetic fields.
- » DO NOT subject equipment to vibrations.
- » DO NOT cover ventilation openings when equipment is in use. Always provide enough room around equipment for air to circulate freely through the ventilation openings.
- » DO NOT allow any liquid on or in the unit.
- » Never place the equipment in direct sunlight.

You should have the following equipment already set up on location:

- a. Television
- b. OneTouch keypads
- c. OneTouch Site Controller
- d. VCR
- e. PowerVu Satellite Receiver
- f. VHF/UHF Splitter (this may not be at all locations)

A. DISCONNECTION INSTRUCTIONS

1. Turn off TV, VCR, OneTouch Site Controller and Scientific-Atlanta PowerVu device.
2. Disconnect all power cords from the wall receptacles.
3. Leave the monitor and Ch.1 L Audio cable plugged into the PowerVu device.
4. Disconnect the other end of the monitor and Ch.1 Audio cable from the other devices (for example: Site Controller, VCR, Modulator, TV.)
5. Disconnect all other cables from all devices.
6. Remove the OneTouch Site Controller and dispose according to instructions.

B. DISPOSAL INSTRUCTIONS

Once the MediaGate Router is connected, you will no longer need your OneTouch Site Controller.



SC202

If you have model number **SC202** or **SC210**, please dispose of them pursuant to your local municipality guidelines.



SC210

If you have model number **SC500**, please return this unit to the JCPenney home office:

**JCPenney
 Satellite Services**
 6501 Legacy Drive
 MS 4301
 Plano, TX 75024



SC500

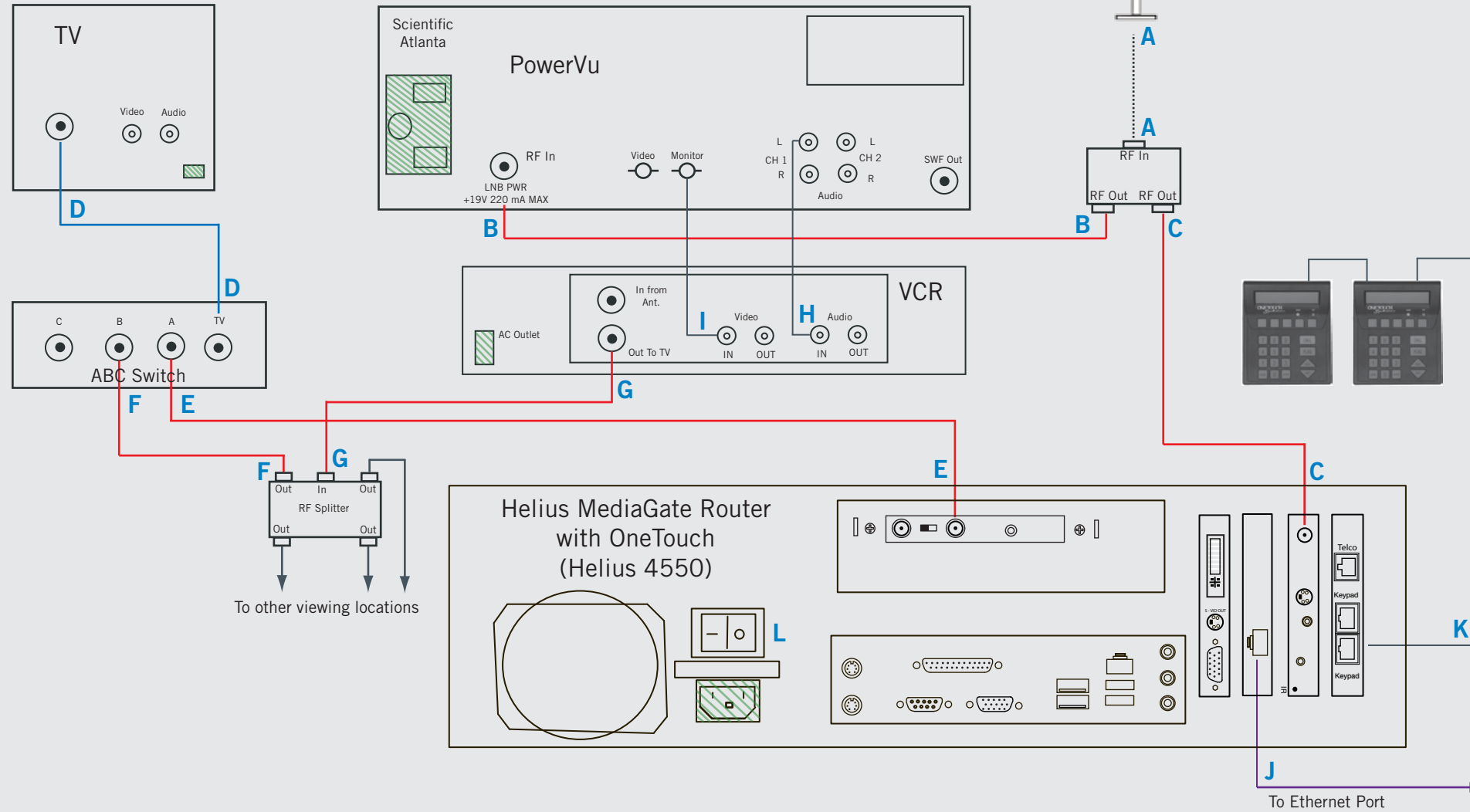

Store without a multiple location splitter

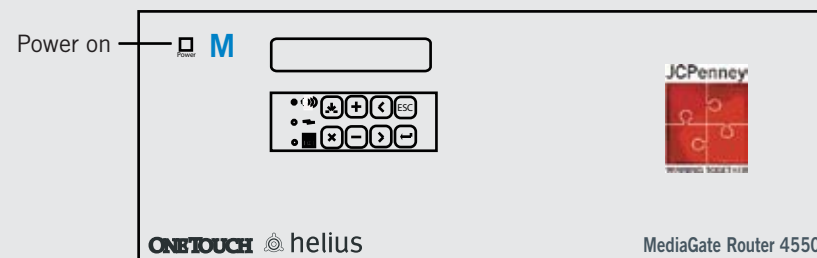
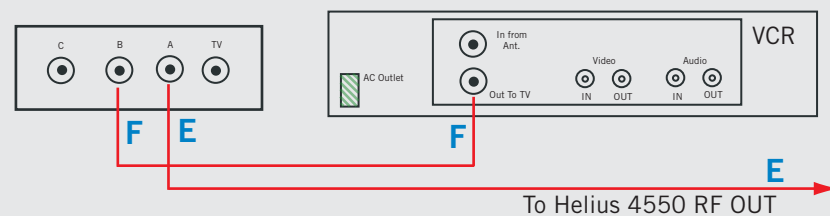

C. INSTALLATION INSTRUCTIONS

UNPACK

1. Remove all items from the Heliu 4550 shipping carton.
2. Stack the 4550, VCR and PowerVu in the order shown at left.

CONNECT SATELLITE

1. Connect the satellite dish cable into the IN on the 2-way splitter. (A)
2. Connect a 3' RF cable in each of the OUT plugs of the same splitter. (B & C)
3. Connect one of the 3' RF cables from the splitter into the PowerVu (B).
4. Connect the other 3' RF cable from the splitter into the Heliu 4550. (C)

TV/VIDEO SETUP

1. a. Connect one end of the 6' RF cable to the A/B/C switch TV OUT. (D)
b. Connect the other end of the 6' RF cable to the RF IN on the TV. (D)
2. a. Connect one 3' RF cable in the A input and one 3' RF cable in the B input of the A/B/C switch. (E & F)
b. Connect the other end of the A switch 3' RF cable to the Heliu 4550 RF OUT. (E)
c. Connect the other end of the B switch 3' RF cable to an OUT on the multiple splitter. (F)
If you do not have a multiple splitter to other locations, connect this cable into the VCR "Out to TV". Please see inset in lower left corner of install guide for illustration. (E & F)
Skip to step 4 if you do not have a multiple splitter.
3. a. Connect the last 3' RF cable into the VCR "Out to TV". (G)
b. Connect the other end of the cable into the IN on the multiple splitter. (G)
4. Connect the Ch. 1 L cable on the PowerVu to the VCR "Audio IN". (H)
5. Connect the Monitor cable on the PowerVu to the VCR "Video IN". (I)

CONNECT ETHERNET AND KEYPADS

1. Plug the ethernet cable into the Heliu 4550. (J)
2. Plug the keypads into the Heliu 4550. (K)

POWER ON

1. Plug all power cords into the wall outlet(s). [Indicated in GREEN on diagram.]
2. Toggle the power switch on the back of the Heliu 4550 to ON (-). (L)
3. Press and release the power on button on the front of the Heliu 4550. (M)
4. Insert the included batteries into the remote control.
5. Turn the TV on and turn to channel 3. Make sure the VCR is on line 1 or Video.

D. START-UP AND VALIDATION

Once all equipment is properly connected and powered on, the Heliu 4550 will boot up and begin video playback. This process takes about two minutes.

Press button A on the A/B/C switch to view the JCPenney video being played from the 4550.

Point the remote control at the infrared eye on the front of the 4550 while selecting buttons. Press 9876, then OK on the remote control.

A self test will occur to make sure the 4550 is set up correctly. Once completed, three status messages will appear. If all three messages indicate success, press button B on the A/B/C switch to view Live Broadcasting.

If any status message displays "Failed"
Contact Satellite Services at 1.800.831.6206 ext. 1